

產品名稱	料號
寶馬頭線端母接頭8P	JTWP-BM08-CF02
寶馬頭線端母接頭9P	JTWP-BM09-CF02
寶馬頭線端母接頭10P	JTWP-BM10-CF02
寶馬頭線端母接頭11P	JTWP-BM11-CF02

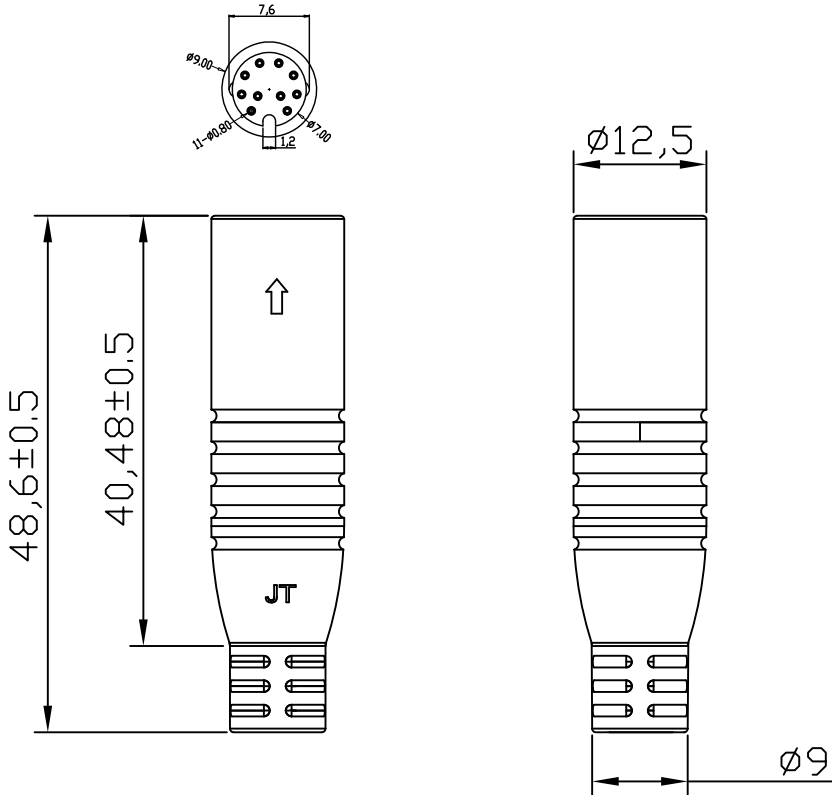

- 材料:
 胶芯: PBT
 端子: 黄铜。
- 表面处理:
 母端子: 镀金

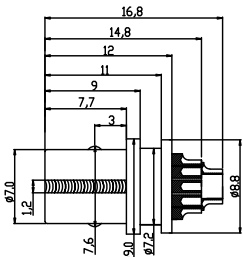

PIN	8P	9P	10P	11P
對插面				

- Note:
- Electrical Performance
 - Rated current :3A
 - Rated Voltage : 60 V
 - Insulation resistance : $\geq 20M\Omega$
 - Contact resistance : $\leq 10m\Omega$
 - Mechanical Performance
 - Durability Repeated : Insert and withdraw up to 200 cycles
 - Environmental Performance
 - Ingress Protection : IP66
 - Temperature Range - Operating : $-40^{\circ}C \sim +80^{\circ}C$

		TOLERANCE UNLESS SPECIFIED		朝富科技股份有限公司 JOIN TEK JOIN TEK CORPORATION CO., LTD.		
		LINEAR	ANGLE			
		.X ± 0.30	X.* ± 5°			
		.XX ± 0.20	.X* ± 2°			
		.XXX ± 0.10	.XX* ± 1°			
		日期	2020.07.29			
		審核	JASON			
		製圖	BEAR			
				名稱: 寶馬頭線端 Female 8~11PIN TITLE:		
				料號: JTWP-BMxx-CF02 PART NO.		
更改 REV.	設 變 內 容 MODIFICATION	修改 DRAWN	核准 APPROVED			