

A-Type

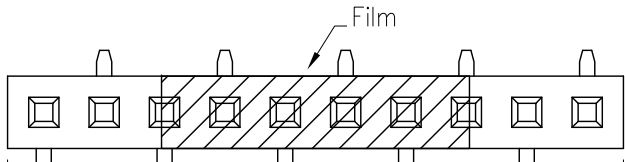

B-Type

#1 $0.4 + 2.0 \times \text{No. of Positions} \pm 0.3$

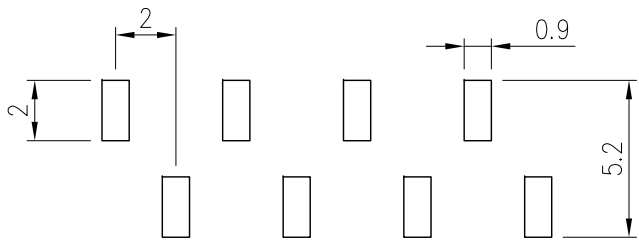
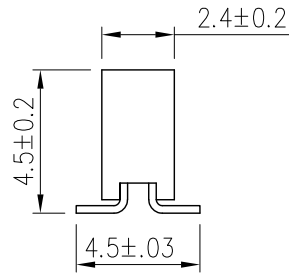
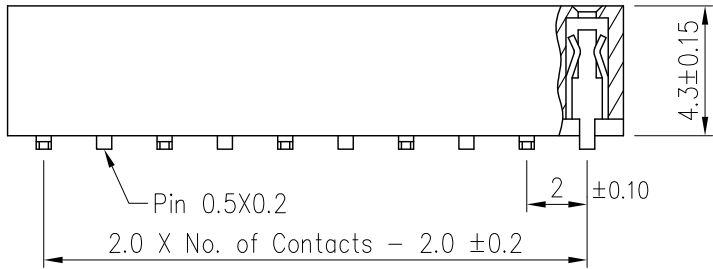

A-Type

PCB Layout

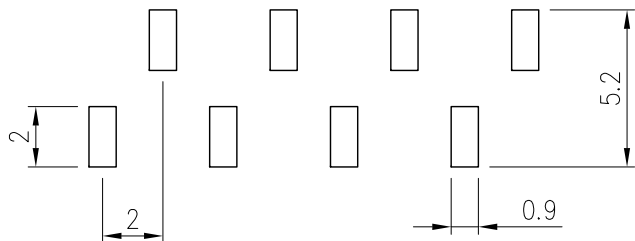

B-Type

Specifications

Current Rating : 2 Amps
 Insulator Resistance : 1000 Megohms min.
 Contact Resistance : 20 m ohms max.
 Dielectric Withstanding : AC 500V
 Operating Temperature : -40°C ~ +105°C
 Max. Process Temp. : 230°C for 30~60 Seconds
 (260°C for 10 Seconds)
 Contact Material : Phosphor Bronze
 Insulator Material : Polyester, UL 94V-0
 Standard : Nylon-6T
 Contact Plated : Full Gold, Full Tin, Selective Plated

Order Information

Serial No. SB6 3- X 1 XX - 0 XX X

Terminal Type 3 : SMT Type
 PIN Type
 A : A Type
 B : B Type
 Row Type 2 : Dual Rows
 No. of Contact per Row
 Dim Type
 Contact Plated

Packing List
 A : In Tube
 B : W/Cap In Tube
 C : W/Film In Tube
 D : W/Cap In Tape & Reel
 E : W/Film In Tape & Reel

Contact Plating Type		
Full Gold Plating	Duplex Plating Gold Plated On Contact Area Tin Plated On Solder Area	Full Tin Plating
GF : Gold Flash G1 : Gold 3u" G2 : Gold 5u" G3 : Gold 10u" G4 : Gold 15u"	HF : Gold Flash, Tin 100u" H1 : Gold 3u", Tin 100u" H2 : Gold 5u", Tin 100u" H3 : Gold 10u", Tin 100u" H4 : Gold 15u", Tin 100u"	T1 : Tin 100u"

.X±0.30	.X±	單位 : MM	朝富科技股份有限公司 名稱 : Female Header P2.0mm Profile : 4.3mm, Single Rows, SMT Type 圖號 : SB63-01XX
.XX±0.20	.XX±	料號 : SB63-X1XX-0XX0	
.XXX±0.10	.XXX±	日期 : 2005/11/24	
本藍圖為朝富科技股份有限公司所有,未經本公司書面許可,嚴禁印製			審核 : 製圖 : Sam
ECN 設變	MODIFICATION 設變內容	DRAWN 修改	APPROVED 核准
			SCALE SHEET REV. 1/1 A